

Important Safety Instructions

Read and understand all these safety instructions before using the product.







During installation, beware of the recoil of the monitor arm body when attaching or detaching the laptop holder to the monitor arm. To prevent damage or injury when changing the monitor arm configuration, always raise the arm to its highest position before a monitor or laptop holder is detached.

Do not attempt to disassemble, service or modify the product.

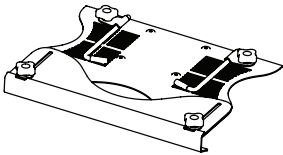
Use only a slightly damp cloth to clean the monitor arm surface. Never use flammable solvents like alcohol, benzene, thinner, etc. on the product.

List of Parts

A Laptop Holder Assembly Qty: 1	B #8 x 32 x 1/2 Phillips Screws Qty: 4	C #8 x 32 Keps Nuts Qty: 4	C Velcro® Qty: 4
			

Verify that you have all the hardware and tools needed for the assembly

Check your packages against the parts list above to verify that you have all the parts needed. You will also need the following tool:

#2 tip Phillips screwdriver

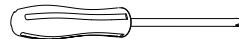

1 Attach Laptop Holder to Monitor Arm

- a** Insert 4 screws (B) through the top of the Laptop Holder (A) and into the VESA plate of a Poise or Willow arm. Secure with Keps Nuts (C) with bolt facing down.

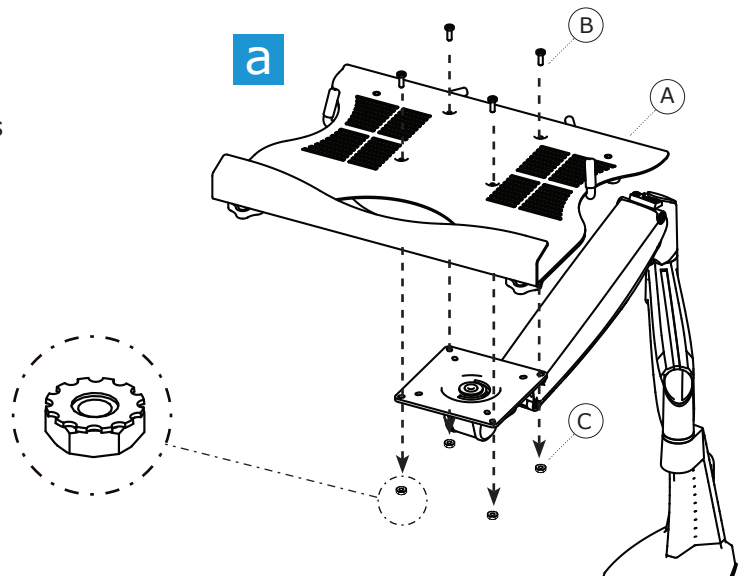

2 Adjust depth, attach docking station if desired

- a The depth of the laptop holder is adjustable. If a docking station is to be used, attach the docking station to the laptop before adjusting the depth of the laptop holder.
- b To adjust the depth, loosen the two knobs under the front of the laptop holder, slide the tray to the desired depth and tighten the knobs.

After adjusting the front plate, attach Velcro (D) to the bottom of the docking station with laptop connected. Remove adhesive backing and position into holder.

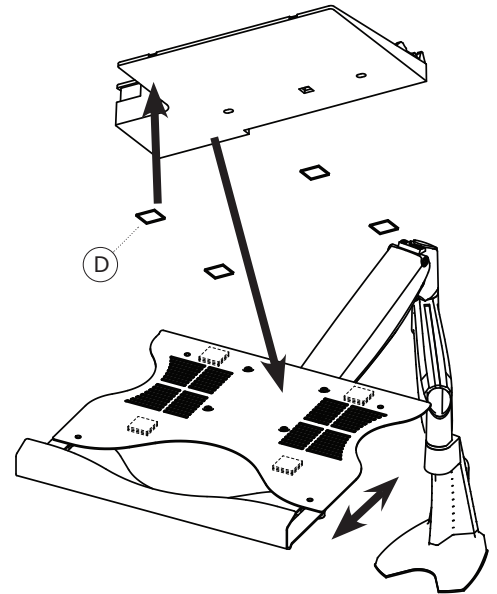

3 Adjust side bars to limit horizontal movement

- a If a docking station is used it is recommended to not use the side bars.

To adjust the side bars, loosen the rear clamp knobs on each side. Slide the bars out and turn them so that the rubber cap points up. Slide the rods in until they contact the laptop. It may be necessary to move the rods forward or back to allow clearance for USB ports or other connections and drives. Once the rods are in position, retighten the clamp knobs.

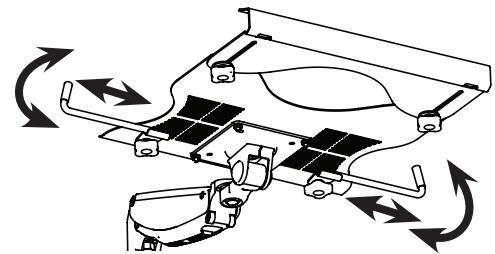

4 Adjust monitor arm balance as needed

- a Once installation is complete it may be necessary to adjust the balance of the monitor arm. See the instructions supplied with the monitor arm for directions.