

Workrite Glide Parts

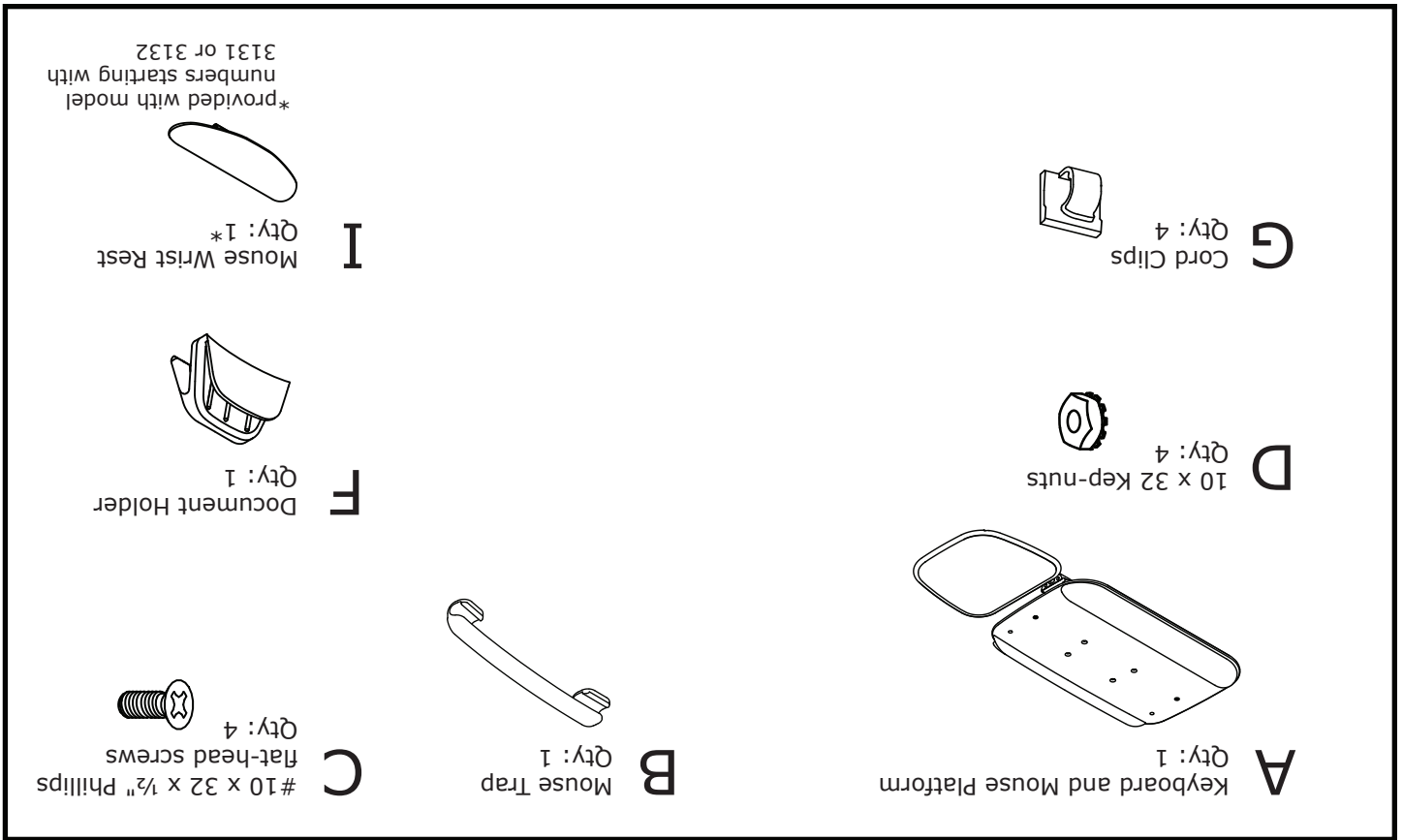

Workrite

ergonomics®

Verify that you have all the hardware needed for the assembly.

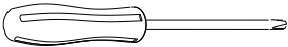

#2 Phillips-head Screwdriver

Installation Instructions for Workrite Glide™



Workrite
ergonomics®

1 Slide Mouse Trap onto back edge of Mouse Platform.

2 Attach Platform to Track Arm using four Screws and Kep-nuts provided.

Note: If installing on Locking Lever Arm, use longer bolts provided with the Locking Lever Arm - not the screws in this kit.



3 Snap Document Holder onto back of Keyboard Platform.

4 Adhere Cord Clips to sides of Track Arm.

5 If provided, clip Mouse Wrist Rest onto Mouse Platform.

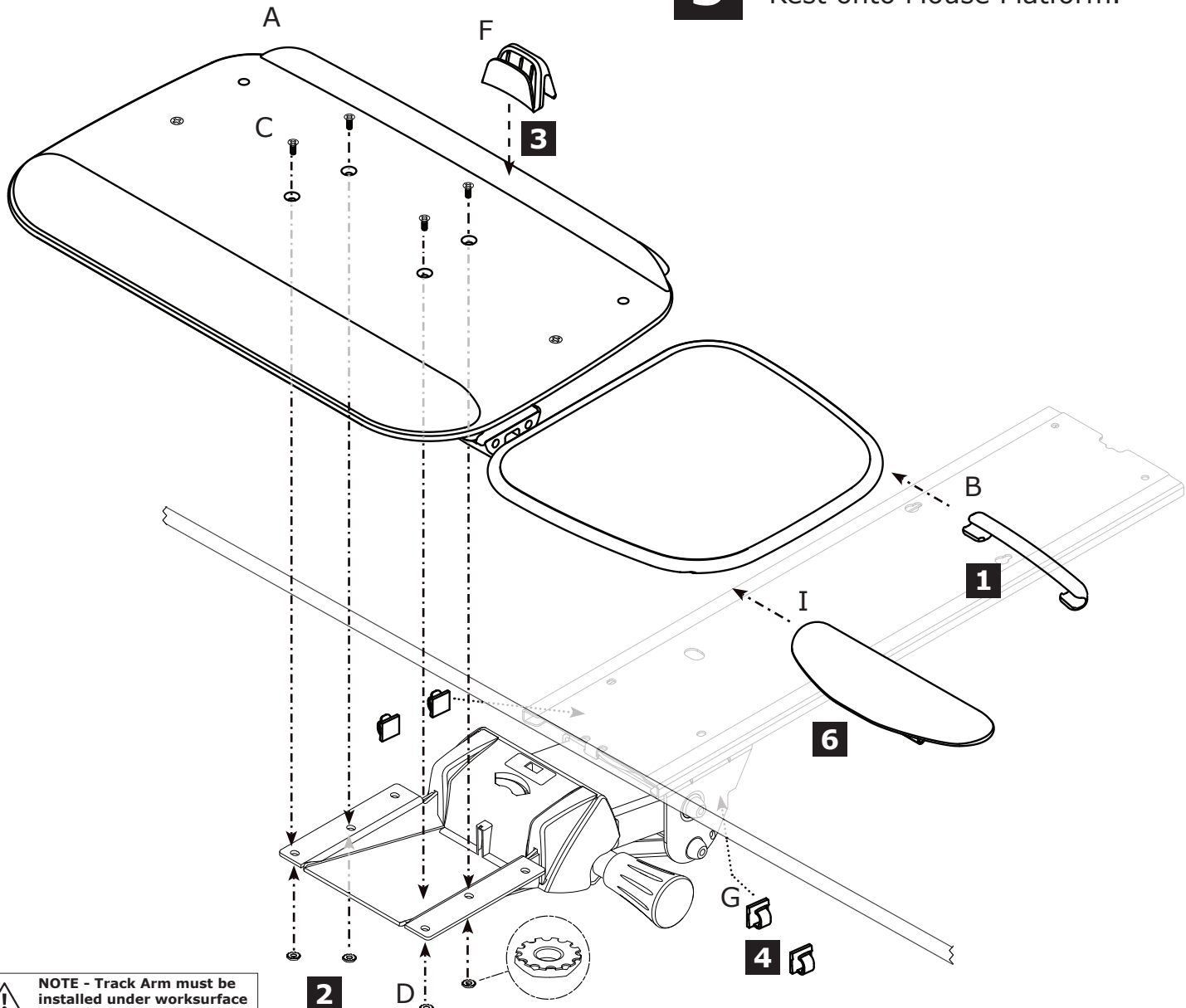

! NOTE - Track Arm must be installed under worksurface before attaching Platform.