



VALUE SOLUTIONS FOR KEYBOARDING FLEXIBILITY

The versatile Advantage keyboard platform is available with single or dual mouse surfaces and can be used in both straight and corner work center applications. The platform is constructed from durable ultra-thin phenolic and features a built-in document holder and cable management.

Advantage Single and Advantage Dual are both available as solo platforms or as part of complete systems that include our Pinnacle 2 Value keyboard arm with nylon glide track in 17" or 22" lengths.

The Advantage Single and Dual platforms come with a Lifetime Warranty and can be relied upon to provide years of reliable, maintenance-free performance and reliability.



Advantage-Single can position the mouse platform on either the right or left hand side.

ADVANTAGE—SINGLE & DUAL

Products listed on this page are available through GSA Contract GS-28F-0030S SIN #711-2 (Schedule 71)



Advantage Systems

Keyboard platform:

- Optimizer document holder & cable management
- UltraThin™ .25" solid phenolic construction
- Memory foam palm support
- Available in black

Mouse surface:

- Single or Dual Mouse-Under design swivels out for use and in for storage
- Simple hand tools required right/left reversible
- Mouse pad palm support sold separately

Keyboard arm:

- System includes 3175 Pinnacle 2 Value keyboard arm:
- Adjusts from flush to 6" below work surface
- No knob/no lever Lift-n-Lock height adjustment
- 25° tilt range: -15° +10°
- Smooth nylon glide track
- 360° arm swivel at track
- Fully stores on 22" track
- Exceeds front of track 3" on 17" track

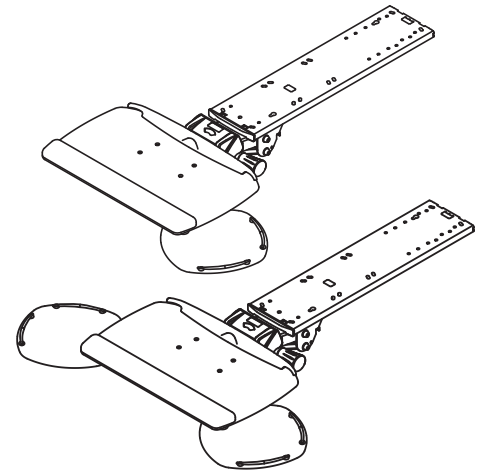

Desk compatibility

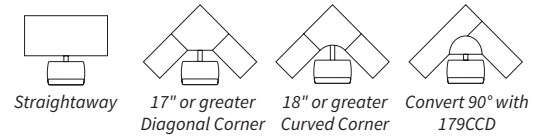

Dimensions

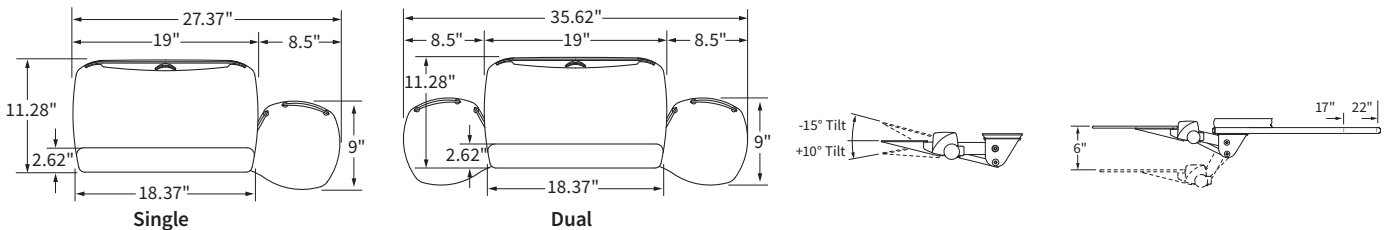

Advantage-Single System

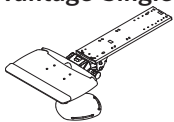

Track Length	Model #	Quick Ship
17"	2144-17	
22"	2144-22	●

Advantage-Dual System

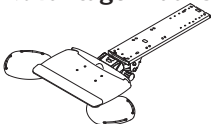

17"	2112-17	
22"	2112-22	

Accessories:

Mouse Palm Support	2120-25
Positive Tilt Lockout Kit	3170-P2NPT
Corner Diagonal for 90°	179CCD-1 1/2B

Replacement Parts:

Keyboard Palm Support	AKP-KPS-18.4-25
Mouse Platform	UB2115
Mouse Surface	AKP-MS-STD
Hardware Kit	AKP-HDWR-ULT
Solo Platform, Single Mouse	UB2110RL25
Solo Platform, Dual Mouse	UB2110D25