

# Workrite Pinnacle 2™ Value

ergonomics®

## Installation Instructions

Tools Required:

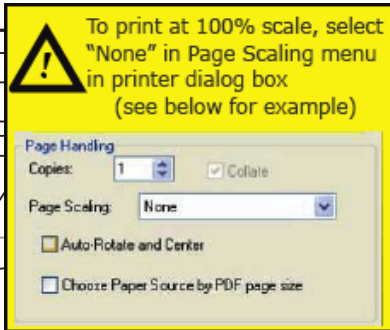
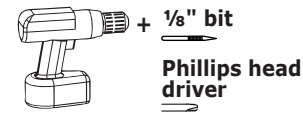

Ø1/8" x 3/4" deep Pilot Hole

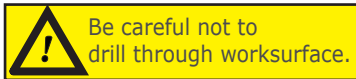

Front edge of worksurface

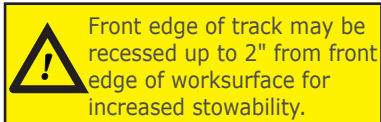

3 5/8"

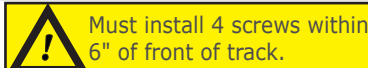

Ø1/8" x 3/4" deep Pilot Hole

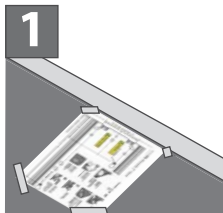

1

Tape template to underside of worksurface.  
Position template so dashed line runs along front edge of worksurface.

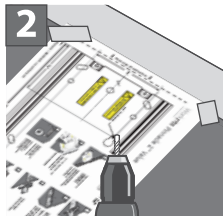

2

Drill 1/8" diameter x 3/4" deep pilot holes at marked locations.  
Remove template.

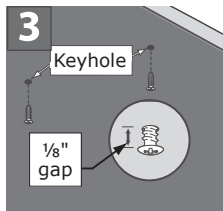

3

Install two #12 x 3/4" wood screws into keyhole pilot holes.  
Leave a gap of approximately 1/8" between head of screw and worksurface.

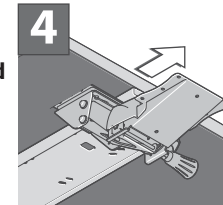

4

Slide arm head out of track.

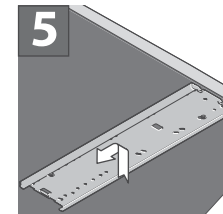

5

Slide track keyholes onto screws.  
Tighten keyhole screws.  
Drill 1/8" diameter x 3/4" deep pilot holes and install remaining #12 x 3/4" screws.

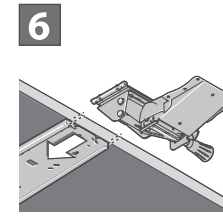

6

Slide arm head onto front of track.

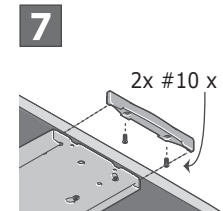

7

Insert plastic cover onto front of track.  
Install two #10 x 1/2" thread-cutting screws through cover and track.

2x #10 x 1/2"

3 3/8"

9 1/2"

1/4"